



# G-Line Series

STX | MTX | XLT



**MTX**

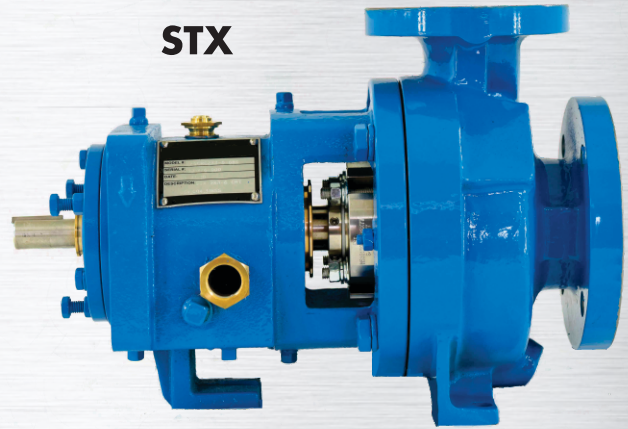

**STX**



**XLT**

Sectional View (STX)

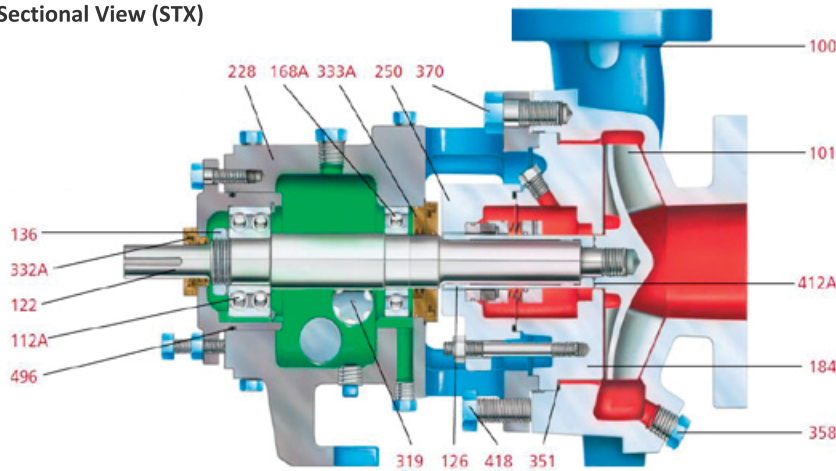

Sectional View (MTX)

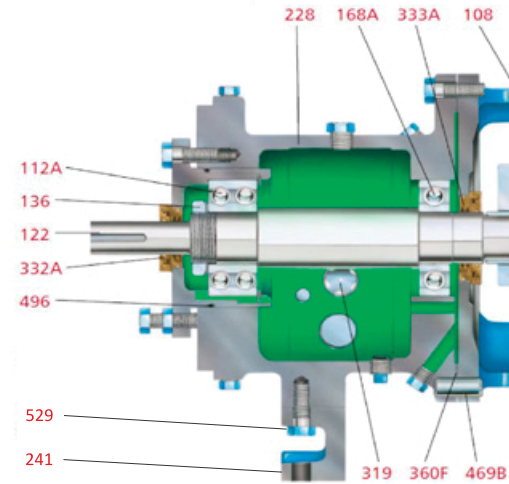

## Specifications

- Manufactured to meet ANSI/ ASME B73.1 standard
- SKF bearings
- Standard, large and modified seal chambers
- Multiple materials of construction available ( WCB & CD4 )
- Open impeller design
- 100% interchangeable with Goulds 3196
- STX, MTX, and XLT models
- LTX & Low Flow also available in select sizes
- Orion Bearing Isolators

PARTS LIST & MATERIALS OF CONSTRUCTION

ITEM NUMBER	PART NAME	MATERIAL			
		WCB	316SS	CD4MCU	
100	Casing	WCB	CD4MCu		
101	Impeller	WCB	CD4MCu		
108	Frame Adapter		WCB		
109C	Cover, Bearing Outboard (XLT Only)		WCB		
112A	Thrust Bearing		Double Row Angular Contact		
122	Shaft-Less Sleeve (Optional)		316SS		
122	Shaft-With Sleeve		4140		
126	Shaft Sleeve		316SS		
136	Bearing Locknut & Lockwasher		Steel		
168A	Radial Bearing		Single Row Ball		
184	Seal Chamber/Stuffing Box Cover	WCB		CD4MCu	
228	Bearing Frame		WCB		
241	Foot, Frame (MTX & XLT Only)		WCB		
250	Gland		316SS		
319	Oil Sight Glass		Glass / Bronze		
332A	Bearing Isolator (Outboard)		Bronze w/Viton O-Rings		
333A	Bearing Isolator (Inboard)		Bronze w/Viton O-Rings		
351	Casing Gasket		Teflon		
358	Casing Drain Plug (Optional)	Grade 5	316SS		
360F	Gasket, Frame-to Adapter (MTX & XLT Only)		Vellumoid		
360C	Gasket, Bearing End Cover (XLT Only)		Vellumoid		
370	Bolt, Adapter-to-Case	Grade 5			
412A	O-Ring, Impeller		Teflon		
418	Jacking Bolt, Adapter-to Case		Grade 5		
469B	Dowel Pin, Frame-to Adapter		Steel		
496	O-Ring, Bearing Housing		Buna N		
529	Bolt, Frame Foot to Frame (MTX & XLT Only)		Grade 5		

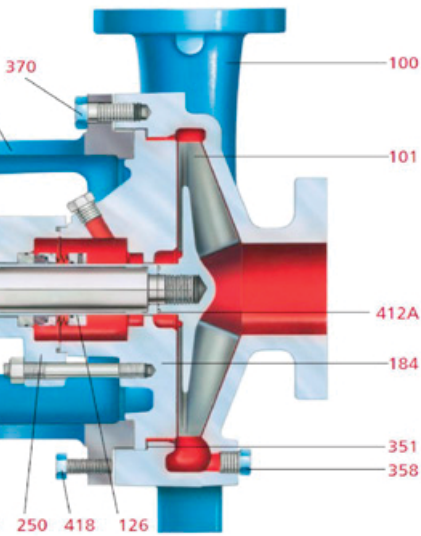

Sectional View (XLT)

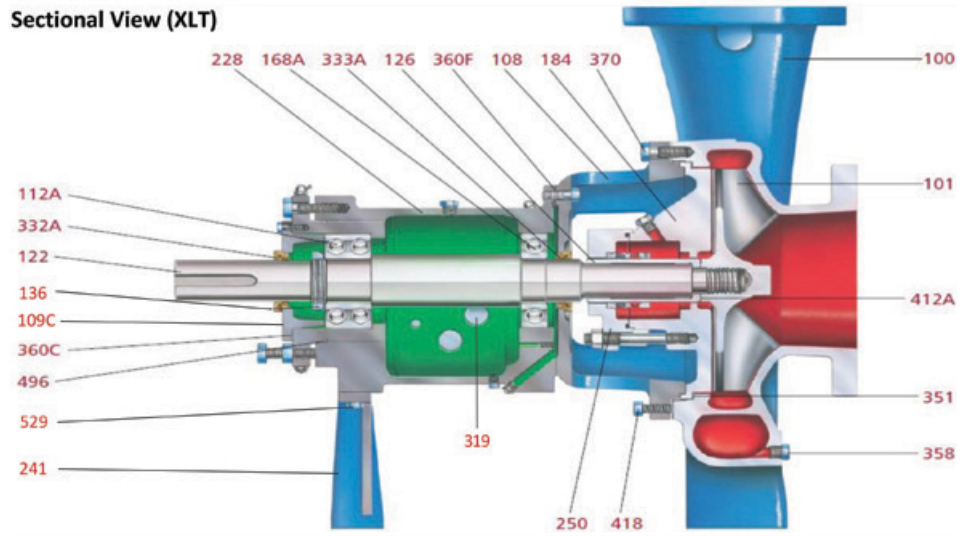

	PUMP SIZE	DISCHARGE	SUCTION	CP	D	X	O	E <sub>1</sub>	E <sub>2</sub>	F	U	Y	V min.	H
STX	1x1.5-6	1	1.5	17.5	5.25	6.5	11.75	6	0	7.25	0.875	4	2	0.625
	1.5x3-6	1.5	3	17.5	5.25	6.5	11.75	6	0	7.25	0.875	4	2	0.625
	2x3-6	2	3	17.5	5.25	6.5	11.75	6	0	7.25	0.875	4	2	0.625
	1x1.5-8	1	1.5	17.5	5.25	6.5	11.75	6	0	7.25	0.875	4	2	0.625
	1.5x3-8	1.5	3	17.5	5.25	6.5	11.75	6	0	7.25	0.875	4	2	0.625
MTX	2x3-8	2	3	23.5	8.25	9.5	17.75	9.75	7.25	12.5	1.125	4	2.625	0.625
	3x4-8	3	4	23.5	8.25	11	19.25	9.75	7.25	12.5	1.125	4	2.625	0.625
	3x4-8G	3	4	23.5	8.25	11	19.25	9.75	7.25	12.5	1.125	4	2.625	0.625
	1x2-10	1	2	23.5	8.25	8.5	16.75	9.75	7.25	12.5	1.125	4	2.625	0.625
	1.5x3-10	1.5	3	23.5	8.25	8.5	16.75	9.75	7.25	12.5	1.125	4	2.625	0.625
	2x3-10	2	3	23.5	8.25	9.5	17.75	9.75	7.25	12.5	1.125	4	2.625	0.625
	3x4-10	3	4	23.5	8.25	11	19.25	9.75	7.25	12.5	1.125	4	2.625	0.625
	3x4-10H	3	4	23.5	10	12.5	22.50	9.75	7.25	12.5	1.125	4	2.625	0.625
	4x6-10G	4	6	23.5	10	13.5	23.50	9.75	7.25	12.5	1.125	4	2.625	0.625
	4x6-10H	4	6	23.5	10	13.5	23.50	9.75	7.25	12.5	1.125	4	2.625	0.625
	1.5x3-13	1.5	3	23.5	10	10.5	20.50	9.75	7.25	12.5	1.125	4	2.625	0.625
	2x3-13	2	3	23.5	10	11.5	21.50	9.75	7.25	12.5	1.125	4	2.625	0.625
	3x4-13	3	4	23.5	10	12.5	22.50	9.75	7.25	12.5	1.125	4	2.625	0.625
	4x6-13	4	6	23.5	10	13.5	23.50	9.75	7.25	12.5	1.125	4	2.625	0.625
XLT	6x8-13	6	8	33.875	14.5	16	30.5	16	9	18.75	2.375	6	4	0.875
	8x10-13	8	10	33.875	14.5	18	32.5	16	9	18.75	2.375	6	4	0.875
	6x8-15	6	8	33.875	14.5	18	32.5	16	9	18.75	2.375	6	4	0.875
	8x10-15	8	10	33.875	14.5	18	32.5	16	9	18.75	2.375	6	4	0.875
	8x10-15G	8	10	33.875	14.5	19	33.5	16	9	18.75	2.375	6	4	0.875

**G-Line**  
Dimensional Drawing  
(STX/MTX/XLT)

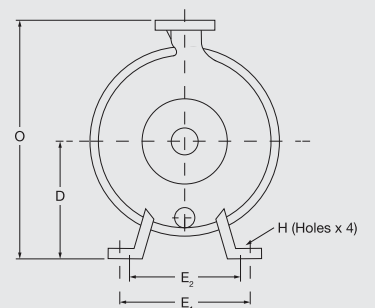
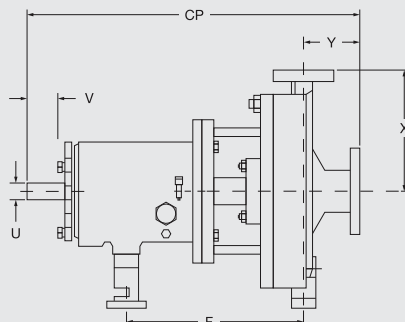

# G-Line Series

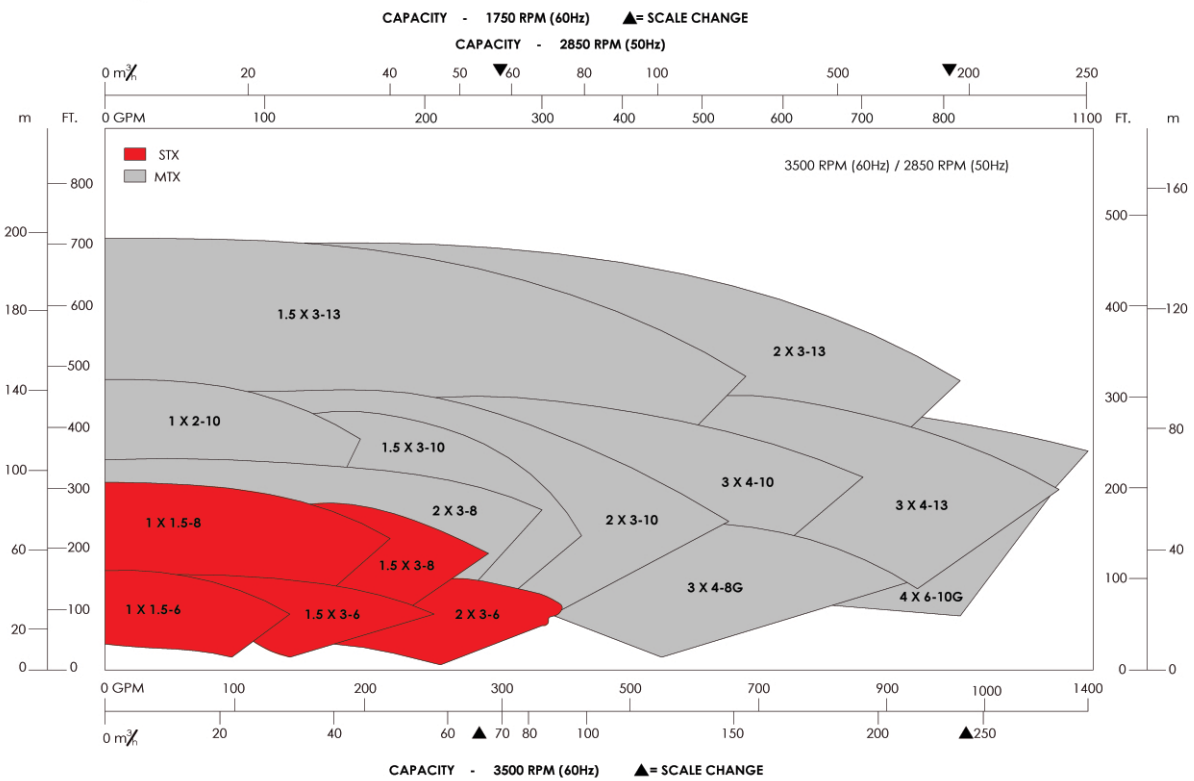
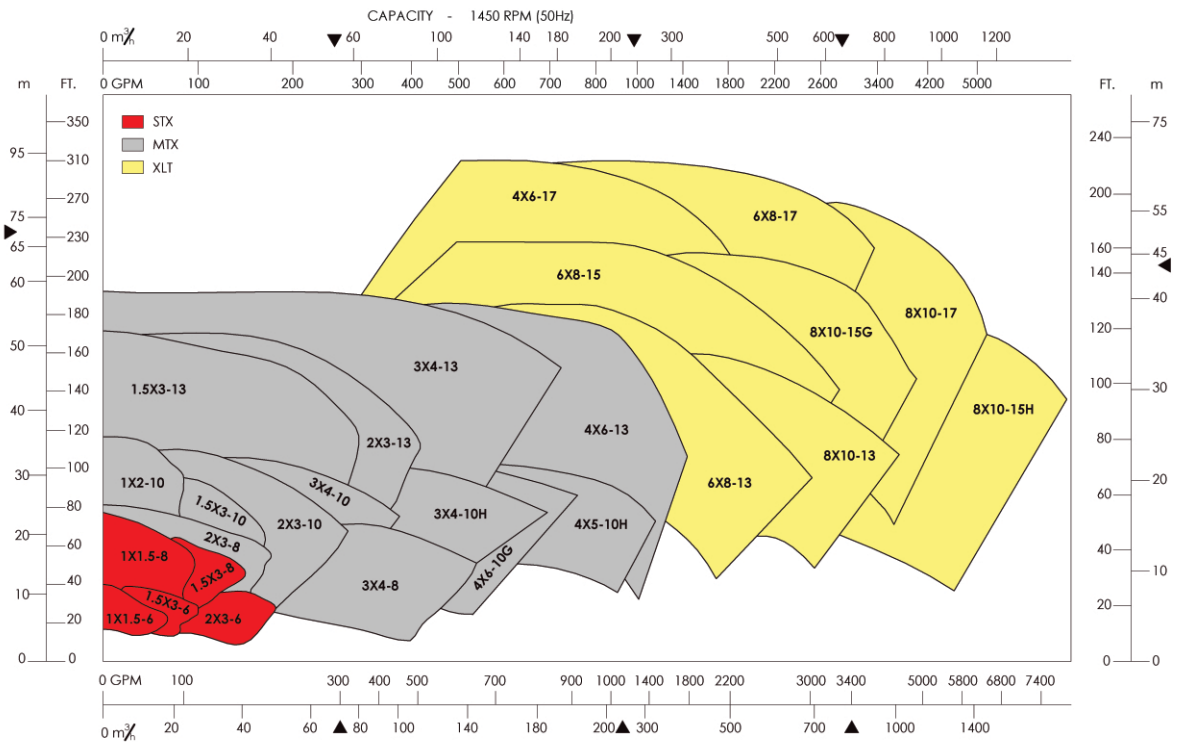

2812 WCR 127  
 Midland, TX 79706  
 432-553-1976  
 info@texasrigequipment.com  
 www.TexasRigEquipment.com

